

LONG RADIUS 45 DEGREE ELBOW NAVSEA 802-5959353 App.B, MSS SP-119

90-10 (UNS C70600) and 70-30 (UNS C71500)
Belled End

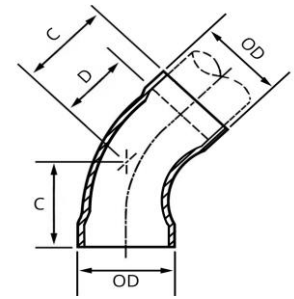

| DIMENSIONS | | | | | | | | |
|-------------------|--------|--------|------|-------|------|-------------|-------------------------|-------------------------|
| NOMINAL PIPE SIZE | OD | C | D | C | D | WEIGHT (lb) | TORK P/N 90/10 | TORK P/N 70/30 |
| | | NAVSEA | | MSS | | | | |
| 1/4 | 0.540 | 1.02 | 0.70 | 1.24 | 0.92 | 0.10 | M110147 | M111121 |
| 3/8 | 0.675 | 1.20 | 0.89 | 1.24 | 0.92 | 0.10 | M110148 | M111122 |
| 1/2 | 0.840 | 1.38 | 1.06 | 1.38 | 1.06 | 0.40 | M110149 | M111123 |
| 3/4 | 1.050 | 1.25 | 0.94 | 1.38 | 1.06 | 0.60 | M110150 | M111124 |
| 1 | 1.315 | 1.50 | 1.12 | 1.50 | 1.12 | 0.70 | M110151 | M111125 |
| 1 1/4 | 1.660 | 1.78 | 1.34 | 1.78 | 1.34 | 0.90 | M110152 | M111126 |
| 1 1/2 | 1.900 | 2.19 | 1.62 | 2.19 | 1.62 | 1.00 | M110153 | M111127 |
| 2 | 2.375 | 2.53 | 1.97 | 2.53 | 1.97 | 2.00 | M110154 | M111128 |
| 2 1/2 | 2.875 | 3.19 | 2.44 | 3.19 | 2.44 | 2.00 | M110155 | M111129 |
| 3 | 3.500 | 3.52 | 2.76 | 3.52 | 2.76 | 4.00 | M110156 | M111130 |
| 3 1/2 | 4.000 | 3.96 | 3.17 | 3.96 | 3.17 | 6.00 | M110157 | M111131 |
| 4 | 4.500 | 4.27 | 3.45 | 4.27 | 3.45 | 7.00 | M110158 | M111132 |
| 5 | 5.563 | 5.14 | 4.20 | 5.14 | 4.20 | 11.00 | M110159 | M111133 |
| 6 | 6.625 | 5.91 | 4.91 | 5.91 | 4.91 | 17.00 | M110160 | M111134 |
| 8 | 8.625 | 7.59 | 6.34 | 7.59 | 6.34 | 22.00 | M110161 | M111135 |
| 10 | 10.750 | 9.22 | 7.78 | 9.22 | 7.78 | 39.00 | M110162 | M111136 |
| 12 | 12.750 | 10.70 | 9.14 | 10.70 | 9.14 | 80.00 | M110163 | M111137 |