

LONG RADIUS 45 DEGREE ELBOW NAVSEA 802-5959353 App.B, MSS SP-119

304 and 316 STAINLESS STEEL
Belled End

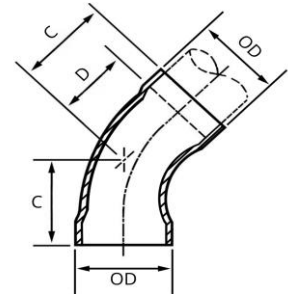

DIMENSIONS								
NOMINAL PIPE SIZE	OD	C	D	C	D	WEIGHT (lb)	TORK P/N 304SS	TORK P/N 316SS
		NAVSEA		MSS				
1/4	0.540	1.02	0.70	1.24	0.92	0.10	M123121	M125903
3/8	0.675	1.20	0.89	1.24	0.92	0.10	M123122	M125904
1/2	0.840	1.38	1.06	1.38	1.06	0.40	M123123	M125905
3/4	1.050	1.25	0.94	1.38	1.06	0.60	M123124	M125906
1	1.315	1.50	1.12	1.50	1.12	0.70	M123125	M125907
1 1/4	1.660	1.78	1.34	1.78	1.34	0.90	M123126	M125908
1 1/2	1.900	2.19	1.62	2.19	1.62	1.00	M123127	M125909
2	2.375	2.53	1.97	2.53	1.97	2.00	M123128	M125910
2 1/2	2.875	3.19	2.44	3.19	2.44	2.00	M123129	M125911
3	3.500	3.52	2.76	3.52	2.76	4.00	M123130	M125912
3 1/2	4.000	3.96	3.17	3.96	3.17	6.00	M123131	M125913
4	4.500	4.27	3.45	4.27	3.45	7.00	M123132	M125914
5	5.563	5.14	4.20	5.14	4.20	11.00	M123133	M125915
6	6.625	5.91	4.91	5.91	4.91	17.00	M123134	M125916
8	8.625	7.59	6.34	7.59	6.34	22.00	M123135	M125917
10	10.750	9.22	7.78	9.22	7.78	39.00	M123136	M125918
12	12.750	10.70	9.14	10.70	9.14	80.00	M123137	M125919