

TEE

NAVSEA 802-5959353 App.B, MSS SP-119

304 and 316 STAINLESS STEEL
 Belled End

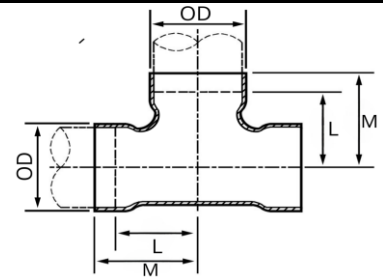

DIMENSIONS						
NOMINAL PIPE SIZE	OD	L	M	WEIGHT (lb)	TORK P/N 304SS	TORK P/N 316SS
		NAVSEA				
1/4	0.540	0.69	0.38	0.10	M123206	M125988
3/8	0.675	0.91	0.59	0.20	M123207	M125989
1/2	0.840	1.09	0.78	0.40	M123208	M125990
3/4	1.050	1.25	0.94	0.50	M123209	M125991
1	1.315	1.50	1.12	0.70	M123210	M125992
1 1/4	1.660	1.88	1.44	0.90	M123211	M125993
1 1/2	1.900	2.25	1.69	2.00	M123212	M125994
2	2.375	2.50	1.94	2.00	M123213	M125995
2 1/2	2.875	3.00	2.25	4.00	M123214	M125996
3	3.500	3.38	2.62	4.00	M123215	M125997
3 1/2	4.000	3.75	2.94	7.00	M123216	M125998
4	4.500	4.12	3.31	8.00	M123217	M125999
5	5.563	4.88	3.94	11.00	M123218	M126000
6	6.625	5.62	4.62	18.00	M123219	M126001
8	8.625	7.00	5.75	36.00	M123220	M126002
10	10.750	8.50	7.06	67.00	M123221	M126003
12	12.750	10.00	8.43	135.00	M123222	M126004