

REDUCING TEE

ANSI B16.9

Buttweld, Schedule 40

5086 Aluminum

6061 Aluminum

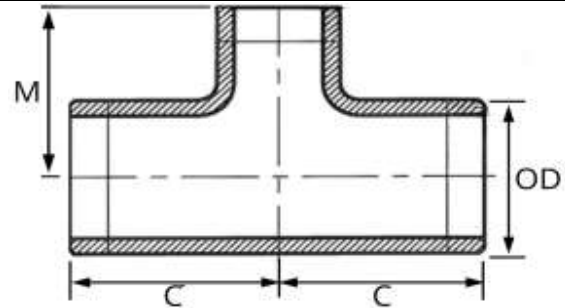

DIMENSIONS

NOMINAL PIPE SIZE	OD	C	M	WEIGHT (lb)	TORK P/N 5086	TORK P/N 6061
1 1/4 x 1 1/4 x 3/4	1.66 x 1.66 x 1.05	1.88	1.88	0.4	M139771	M140116
1 1/4 x 1 1/4 x 1	1.66 x 1.66 x 1.315	1.88	1.88	0.4	M139772	M140117
1 1/2 x 1 1/2 x 1/2	1.9 x 1.9 x 0.84	2.25	2.25	0.6	M139773	M140118
1 1/2 x 1 1/2 x 3/4	1.9 x 1.9 x 1.05	2.25	2.25	0.6	M139774	M140119
1 1/2 x 1 1/2 x 1	1.9 x 1.9 x 1.315	2.25	2.25	0.6	M139775	M140120
1 1/2 x 1 1/2 x 1 1/4	1.9 x 1.9 x 1.66	2.25	2.25	0.6	M139776	M140121
2 x 2 x 1/2	2.375 x 2.375 x 0.84	2.50	2.50	0.8	Inquire	Inquire
2 x 2 x 3/4	2.375 x 2.375 x 1.05	2.50	2.50	0.8	M139777	Inquire
2 x 2 x 1	2.375 x 2.375 x 1.315	2.50	2.50	0.8	M139778	M140122
2 x 2 x 1 1/4	2.375 x 2.375 x 1.66	2.50	2.50	0.8	M139779	M140123
2 x 2 x 1 1/2	2.375 x 2.375 x 1.9	2.50	2.50	1	M139780	M140124
2 1/2 x 2 1/2 x 1	2.875 x 2.875 x 1.315	3.00	3.00	1	M139781	M140125
2 1/2 x 2 1/2 x 1 1/4	2.875 x 2.875 x 1.66	3.00	3.00	1	M139782	M140126
2 1/2 x 2 1/2 x 1 1/2	2.875 x 2.875 x 1.9	3.00	3.00	1.5	M139783	M140127
2 1/2 x 2 1/2 x 2	2.875 x 2.875 x 2.375	3.00	3.00	1.5	M139784	M140128
3 x 3 x 1/2	3.5 x 3.5 x 0.84	3.38	3.38	2	Inquire	Inquire
3 x 3 x 3/4	3.5 x 3.5 x 1.05	3.38	3.38	2	Inquire	Inquire
3 x 3 x 1	3.5 x 3.5 x 1.315	3.38	3.38	2	M139787	M140131
3 x 3 x 1 1/4	3.5 x 3.5 x 1.66	3.38	3.38	2	M139788	M140132
3 x 3 x 1 1/2	3.5 x 3.5 x 1.9	3.38	3.38	2	M139789	M140133
3 x 3 x 2	3.5 x 3.5 x 2.375	3.38	3.38	2	M139790	M140134
3 x 3 x 2 1/2	3.5 x 3.5 x 2.875	3.38	3.38	2	M139791	M140135
3 1/2 x 3 1/2 x 1 1/2	4 x 4 x 1.9	3.75	3.75	3	M139794	M140138
3 1/2 x 3 1/2 x 2	4 x 4 x 2.375	3.75	3.75	3	M139795	M140139
3 1/2 x 3 1/2 x 2 1/2	4 x 4 x 2.875	3.75	3.75	3	M139796	M140140
3 1/2 x 3 1/2 x 3	4 x 4 x 3.5	3.75	3.75	4	M139797	M140141
4 x 4 x 1 1/2	4.5 x 4.5 x 1.9	4.13	4.13	4	M139799	M140143
4 x 4 x 2	4.5 x 4.5 x 2.375	4.13	4.13	4	M139800	M140144
4 x 4 x 2 1/2	4.5 x 4.5 x 2.875	4.13	4.13	4	M139801	M140145
4 x 4 x 3	4.5 x 4.5 x 3.5	4.13	4.13	4	M139802	M140146
4 x 4 x 3 1/2	4.5 x 4.5 x 4	4.13	4.13	4.5	M139803	M140147
5 x 5 x 2	5.56 x 5.56 x 2.375	4.88	4.88	7	M139805	M140150
5 x 5 x 2 1/2	5.56 x 5.56 x 2.875	4.88	4.88	7	M139806	M140151
5 x 5 x 3	5.56 x 5.56 x 3.5	4.88	4.88	7	M139807	M140152
5 x 5 x 3 1/2	5.56 x 5.56 x 4	4.88	4.88	7	M139808	M140153
5 x 5 x 4	5.56 x 5.56 x 4.5	4.88	4.88	7.5	M139809	M140154

REDUCING TEE ANSI B16.9

Buttweld, Schedule 40

5086 Aluminum

6061 Aluminum

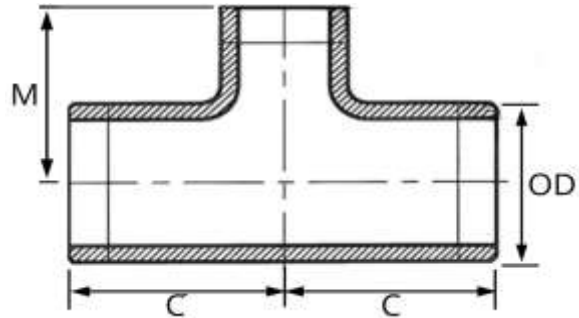

DIMENSIONS

NOMINAL PIPE SIZE				OD		C	M	WEIGHT (lb)	TORK P/N 5086	TORK P/N 6061				
6	x	6	x	2	6.625	x	6.625	x	2.375	5.63	5.63	10	M139811	M140156
6	x	6	x	2 1/2	6.625	x	6.625	x	2.875	5.63	5.63	10	M139812	M140157
6	x	6	x	3	6.625	x	6.625	x	3.5	5.63	5.63	10	M139813	M140158
6	x	6	x	3 1/2	6.625	x	6.625	x	4	5.63	5.63	10	M139814	M140159
6	x	6	x	4	6.625	x	6.625	x	4.5	5.63	5.63	10.5	M139815	M140160
6	x	6	x	5	6.625	x	6.625	x	5.562	5.63	5.63	11	M139816	M140161
8	x	8	x	2 1/2	8.625	x	8.625	x	2.875	7.00	7.00	20	Inquire	Inquire
8	x	8	x	3	8.625	x	8.625	x	3.5	7.00	7.00	20	M139817	M140162
8	x	8	x	3 1/2	8.625	x	8.625	x	4	7.00	7.00	20	M139818	M140163
8	x	8	x	4	8.625	x	8.625	x	4.5	7.00	7.00	20.5	M139819	M140164
8	x	8	x	5	8.625	x	8.625	x	5.562	7.00	7.00	21	M139820	M140165
8	x	8	x	6	8.625	x	8.625	x	6.625	7.00	7.00	21.5	M139821	M140166
12	x	12	x	5	12.75	x	12.75	x	5.562	10.00	10.00	74	Inquire	Inquire
12	x	12	x	6	12.75	x	12.75	x	6.625	10.00	10.00	76	M139826	M140171
12	x	12	x	8	12.75	x	12.75	x	8.625	10.00	10.00	78	M139827	M140172
12	x	12	x	10	12.75	x	12.75	x	10.75	10.00	10.00	81	M139828	M140173
14	x	14	x	6	14	x	14	x	6.625	11.00	11.00	80	Inquire	Inquire
14	x	14	x	8	14	x	14	x	8.625	11.00	11.00	82	Inquire	Inquire
14	x	14	x	10	14	x	14	x	10.75	11.00	11.00	84	Inquire	Inquire
14	x	14	x	12	14	x	14	x	12.75	11.00	11.00	86	M139829	M140174
16	x	16	x	8	16	x	16	x	8.625	12.00	12.00	102	Inquire	Inquire
16	x	16	x	10	16	x	16	x	10.75	12.00	12.00	105	Inquire	M140175
16	x	16	x	12	16	x	16	x	12.75	12.00	12.00	107	Inquire	Inquire
16	x	16	x	14	16	x	16	x	14	12.00	12.00	109	Inquire	Inquire
18	x	18	x	10	18	x	18	x	10.75	13.50	13.50	127	Inquire	Inquire
18	x	18	x	12	18	x	18	x	12.75	13.50	13.50	130	Inquire	Inquire
18	x	18	x	14	18	x	18	x	14	13.50	13.50	133	Inquire	Inquire
18	x	18	x	16	18	x	18	x	16	13.50	13.50	135	Inquire	Inquire
20	x	20	x	12	20	x	20	x	12.75	15.00	15.00	153	Inquire	Inquire
20	x	20	x	14	20	x	20	x	14	15.00	15.00	156	Inquire	Inquire
20	x	20	x	16	20	x	20	x	16	15.00	15.00	158	Inquire	Inquire
20	x	20	x	18	20	x	20	x	18	15.00	15.00	140	Inquire	Inquire
24	x	24	x	14	24	x	24	x	14	17.00	17.00	204	Inquire	Inquire
24	x	24	x	16	24	x	24	x	16	17.00	17.00	208	Inquire	Inquire
24	x	24	x	18	24	x	24	x	18	17.00	17.00	211	Inquire	Inquire
24	x	24	x	20	24	x	24	x	20	17.00	17.00	214	Inquire	Inquire

REDUCING TEE ANSI B16.9

Buttweld, Schedule 40

5086 Aluminum
 6061 Aluminum

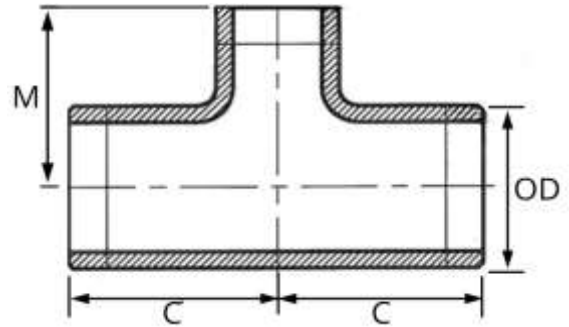

DIMENSIONS

NOMINAL PIPE SIZE					OD					C	M	WEIGHT (lb)	TORK P/N 5086	TORK P/N 6061
30	x	30	x	18	30	x	30	x	18	22.00	22.00	256	Inquire	Inquire
30	x	30	x	20	30	x	30	x	20	22.00	22.00	261	Inquire	Inquire
30	x	30	x	24	30	x	30	x	24	22.00	22.00	267	Inquire	Inquire
36	x	36	x	20	36	x	36	x	20	26.50	26.50	306	Inquire	Inquire
36	x	36	x	24	36	x	36	x	24	26.50	26.50	314	Inquire	Inquire
36	x	36	x	30	36	x	36	x	30	26.50	26.50	322	Inquire	Inquire